

Joerg Hensel – Volunteer c/o
Charter Township of Oakland
4393 Collins Road
Rochester, Michigan 48306
September 19, 2014

LICENSED HERBICIDE APPLICATORS

Dear PHRAGMITES CONTRACTORS:

Thank you in advance for submitting a proposal to treat Phragmites in Oakland Township.

Attached is a map keying in 34 stands of Phragmites along Silverbell and Adams roads. Also, on the next few pages referencing each stand is a chart showing an associated GPS waypoint coordinate. These coordinates are taken along the side of the road that the stand is on, and represents the approximate beginning and end of that stretch of stand, or just location of it if it small.

Please provide a price to treat the 34 stands (of varying size & length) of Phragmites from the roads edge back to the roads legal right of way. The road commission right of ways vary in the area so please access the required depth of treatment based on ROW map shown at the GIS site <https://gis.oakgov.com/propertygateway/home.mvc>

Our budget has changed slightly since we first contacted you. If your price to treat these stands allow us to treat more stands in the area please indicate the cost to treat other stands on either a lineal foot or square footage price so we may add similar roadside treatments.

Some of the treatments will cross bike-walk paths. Please indicate the procedure you will use to keep users off the path away from the area while you are treating, and how long after treatment the path needs to remain closed.

The township is responsible for the DEQ permits if they are needed, and for contacting the road commission to inform them of our plan.

Please submit your proposal ASAP or no later than September 24th via email to michinvasives@aol.com.

Sincerely,

Joerg Hensel- Environmental Steward

Stand Number	Beginning Waypoint	Ending Waypoint	Comments
1	N 42.43.453 W 083.11.730	N 42.43.453 W 083.11.693	EXTENSIVE STAND INTO ADJOINING SUB
2	N 42.43.453 W 083.11.654	N 42.43.453 W 083.11.627	EXTENSIVE STAND 30 FT BEYOND ROW
3	N 42.43.453 W 083.11.505	N 42.43.453 W 083.11.421	
4	N 42.43.459 W 083.11.172		SMALL PATCH AT STOP SIGN
5	N 42.43.453 W 083.11.108	N 42.43.453 W 083.11.063	EXTENSIVE STAND INTO ADJOINING SUB
6	N 42.43.501 W 083.09.846	N 42.43.501 W 083.09.810	ALSO INTO WETLAND TO SOUTH +-50'
7	N 42.43.501 W 083.09.455		@ HIGH VOLT POLE
8	N 42.43.504 W 083.09.875		SMALL PATCH
9	N 42.43.496 W 083.10.167		SMALLPATCH
10	N 42.43.496 W 083.10.528	N 42.43.496 W 083.11.578	
11	N 42.43.496 W 083.10.696	N 42.43.496 W 083.11.724	
12	N 42.43.496 W 083.10.800	N 42.43.496 W 083.11.853	

13.	N 42.43.475 W 083.10.966		HEAVY STAND INTO HOMEARAMA RETENTION POND
14.	N 42.43.468 W 083.11.334	N 42.43.468 W 083.11.360	
15.	N 42.43.462 W 083.11.603	N 42.43.462 W 083.11.743	CONFIRM WHERE PARK MAY ALREADY TREATED WITH JOERG-BEN AT TIME OF APP
16.	N 42.43.567 W 083.11.781	N 42.43.323 W 083.11.781	TO BOARDWALK AND 10 FT BEYOND

JOERG WILL CONTACT HOA HERE IN THIS AREA, AS A LARGE STAND EXIST AT NORTH
SIDE OF KINGS RIDGE RESERVE SUB'S RETENTION POND – 248-373-6200

18.	N 42.43.3647 W 083.11.770	N 42.43.424 W 083.11.770	
19.	N 42.43.568 W 083.11.777	N 42.43.652 W 083.11.780	SCATTERED IN THIS STRETCH
20.	N 42.43.843 W 083.11.788	N 42.43.989 W 083.11.794	SCATTERED IN THIS STRETCH
21.	N 42.44.239 W 083.11.800	N 42.44.328 W 083.11.804	SCATTERED IN THIS STRETCH
22.	N 42.44.367 W 083.11.632	N 42.44.365 W 083.11.789	SCATTERED IN THIS STRETCH TO STOP SIGN
23.	N 42.44.314 W 083.11.809	N 42.44.187 W 083.11.809	
24.	N 42.44.129 W 083.11.805	N 42.44.087 W 083.11.805	

PHRAGMITES CONTRACTORS

September 19, 2014

Page 4

25.	N 42.43.948 W 083.11.806	N 42.43.910 W 083.11.799	LARGE STAND OTHER SIDE OF BIKE TRAIL INCLUDED
26.	N 42.44.888 W 083.11.838	N 42.44.826 W 083.11.832	AT PAINT CREEK
27.	N 42.44.715 W 083.11.830	N 42.44.500 W 083.11.832	SCATTERED UP TO SCHOOLS ENTRANCE
28.	N 42.44.406 W 083.11.808	N 42.44.561 W 083.11.818	
29.	N 42.44.854 W 083.11.828	N 42.44.897 W 083.11.828	DENSE STANDS INTO BJORNSTADS PROP
30.			SMALL STAND AT STOP SIGN
31.	N 42.45.317 W 083.11.848	N 42.45.368 W 083.11.851	
32.	N 42.45.352 W 083.11.855	N 42.45.299 W 083.11.855	
33.	N 42.45.449 W 083.11.855	N 42.45.460 W 083.11.855	
34.	N 42.45.153 W 083.11.887	N 42.46.277 W 083.11.891	4 SCATTERED STANDS ALONG THIS STRETCH

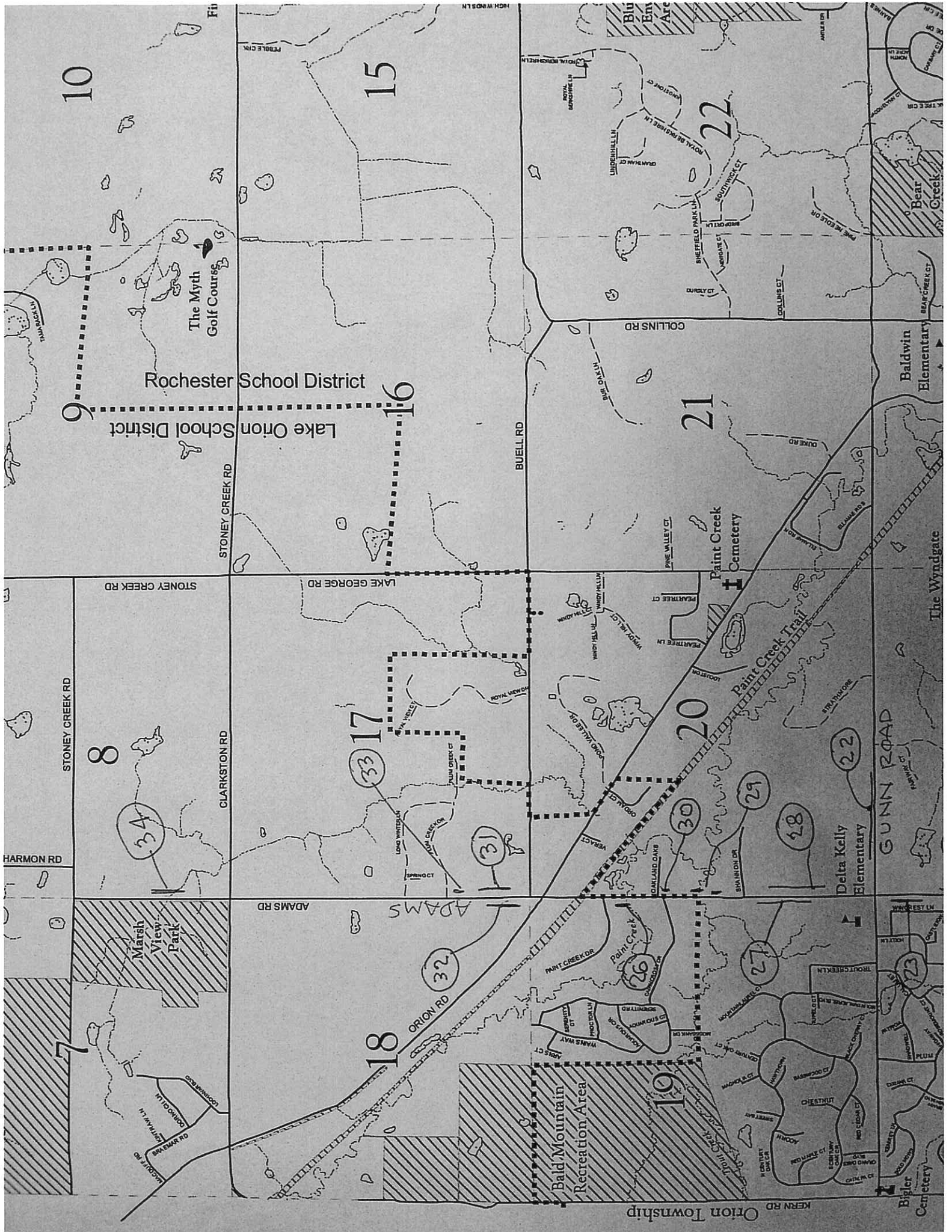

10

15

22

Rochester School District

Lake Orion School District

21

Paint Creek Cemetery

Baldwin Elementary

The Wyndgate

STONEY CREEK RD

LAKE GEORGE RD

BUELL RD

COLLINS RD

COLLINS CT

BEAR CREEK CT

STONEY CREEK RD

8

CLARKSTON RD

33

31

20

29

28

22

GUNN ROAD

Delta Kelly Elementary

HARMON RD

Marsh View Park

ADAMS RD

ADAMS

32

Bald Mountain Recreation Area

19

27

23

7

ORION RD

18

26

25

24

23

Orion Township

KERN RD

Bigler Cemetery

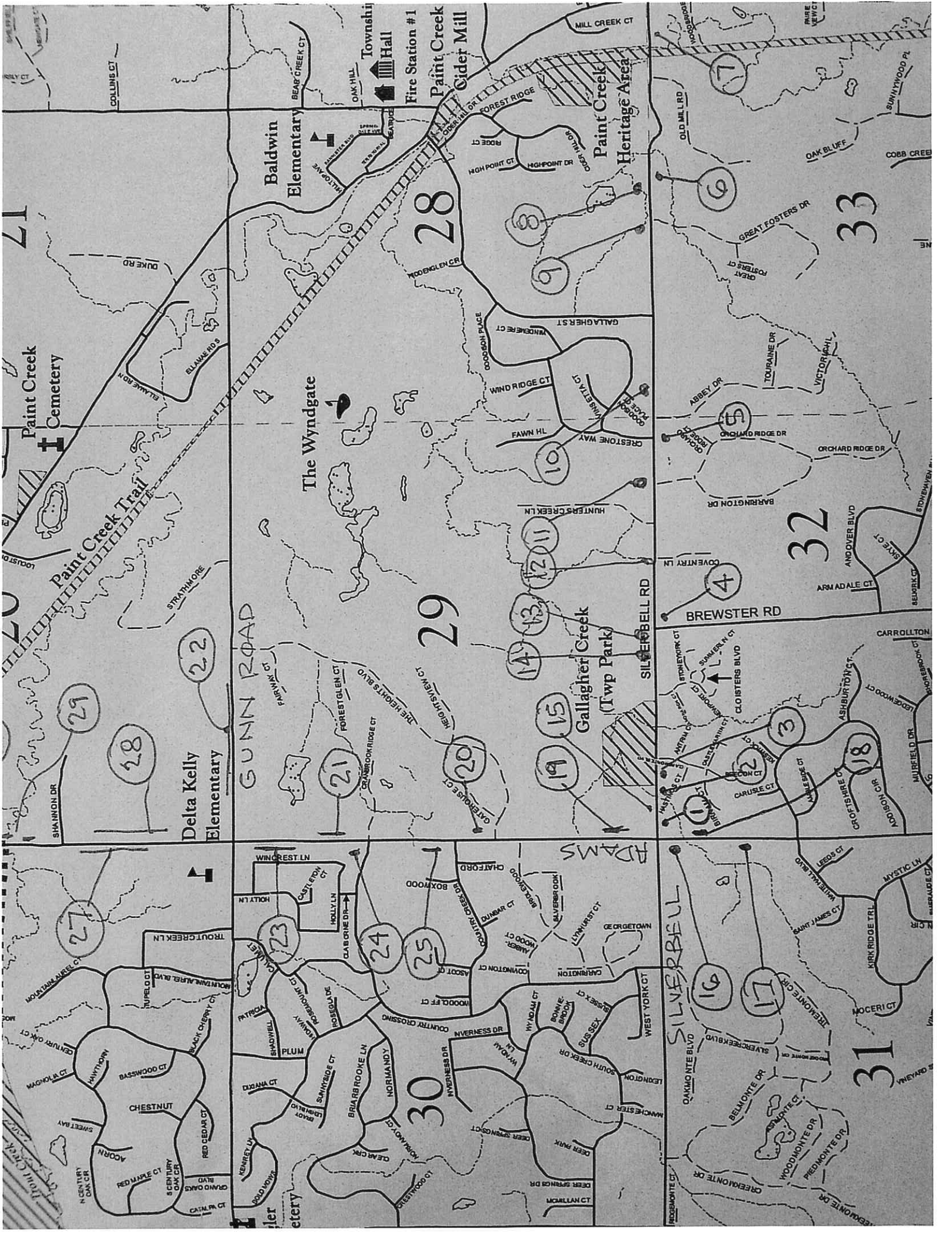

Paint Creek Cemetery
Paint Creek Trail
Baldwin Elementary
Delta Kelly Elementary
Township Fire Station #1
Paint Creek
Older Mill

28
29
30
31
32
33
GUNN ROAD
SILVERBELL RD
BREWSTER RD
The Wyndgate
Gallagher Creek (Twp Park)

Paint Creek Heritage Area
Paint Creek
Older Mill
Gallagher Creek (Twp Park)

27
28
29
30
31
32
33
Paint Creek Cemetery
Paint Creek Trail

20
21
22
23
24
25
26
27
28
29
30
31
32
33
Delta Kelly Elementary
Gallagher Creek (Twp Park)

30
31
32
33
Silverbell
Gallagher Creek (Twp Park)